

Vorderansicht  
front view

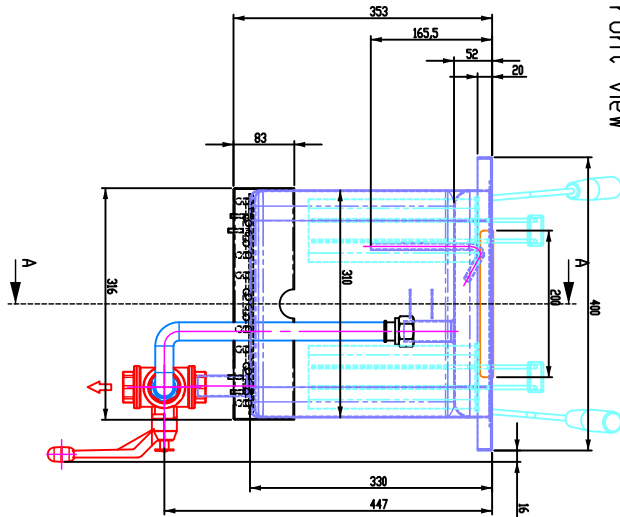

Draufsicht  
top view

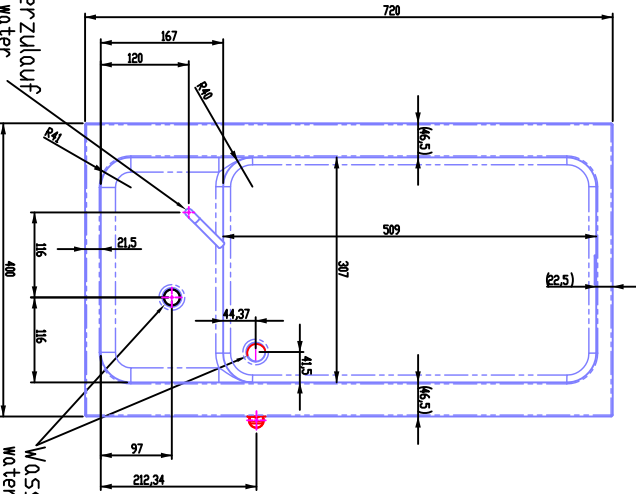

Ausschnitt bei Nudelkocher aufgelegt  
385mm x 705mm  
cut out at cover panel 385mm x 705mm  
Ausschnitt bei Nudelkocher flächenbündig  
eingebaut 408mm x 728mm  
cut out at cover panel 408 mm x 728mm

Schalterblende (optional lieferbar)  
switch panel - optional available

maximale Einbautiefe 110mm  
max installation depth

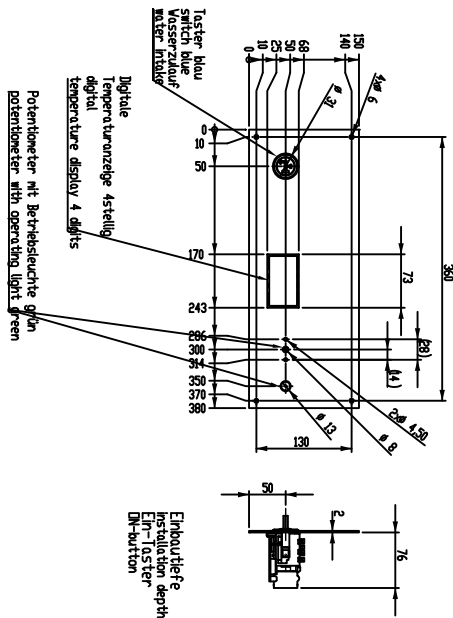

MAX-MIN

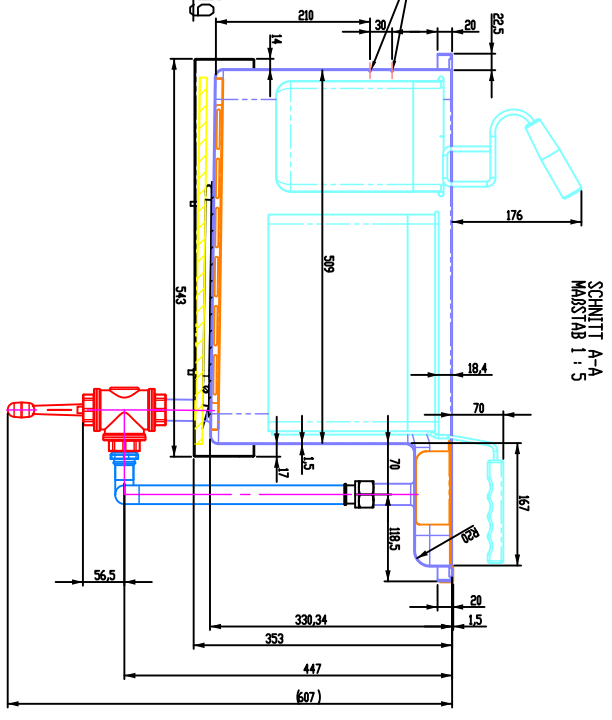

SCHNITT A-A  
MAßSTAB 1:5

Elektrische-Steuereinheit  
electrical control box

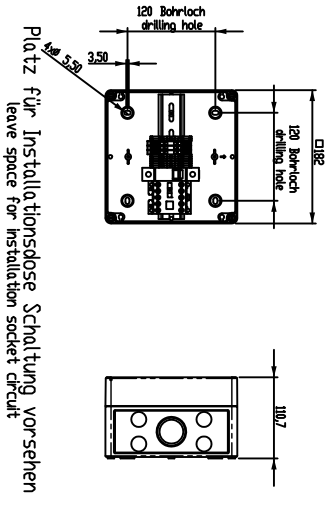

Gerät nicht zum Einschweißen geeignet!  
device is not suitable for welding!

alle Maße in mm  
Allgemeinheit = n

Einbautiefe  
installation depth

Ein-Taste / Line-key  
Kopf - Sensor  
3-Verbindungen  
Fluideur - Fluid valve  
Isolation - Isolation  
Energieleuch - sheet to insert  
Anschließen - sheet for imp-dy  
Niveaueingriff - Niveau control  
Automat-Schalterlauf - auto dral

| ZEICHEN | BESCHREIBUNG   | Menge | Lagerort | SSS  | SSS  | ANMERKUNGEN |            |
|---------|--|-------|----------|------|------|-------------|------------|
|         |  |       |          |      |      | Abfallwert  | Abfallwert |
| 000001  | Berger-Kochsysteme GmbH & Co KG<br>Super-Sensoren<br>Wasserzulauf- und Wasserablauf-Blende | 1     | 1000     | 1000 | 1000 |             |            |
| 000002  | BKEA 1/1E  | 1     | 1000     | 1000 | 1000 |             |            |

Vorderansicht  
front view

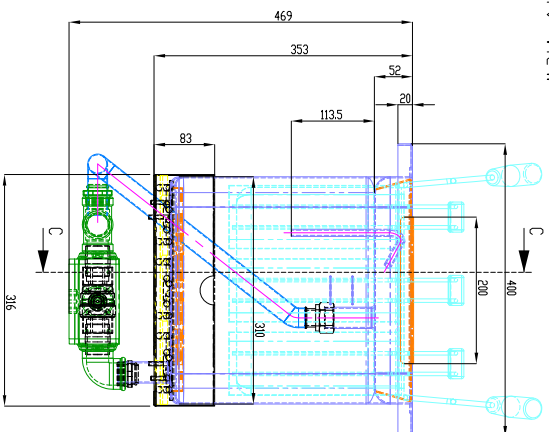

Ausschnitt bei Nudelkocher aufgelegt  
385mm x 705mm  
cut out at cover panel 385mm x 705mm  
Ausschnitt bei Nudelkocher flächenbündig  
eingebaut 408mm x 728mm  
cut out at cover panel 408 mm x 728mm

MAX-MIN

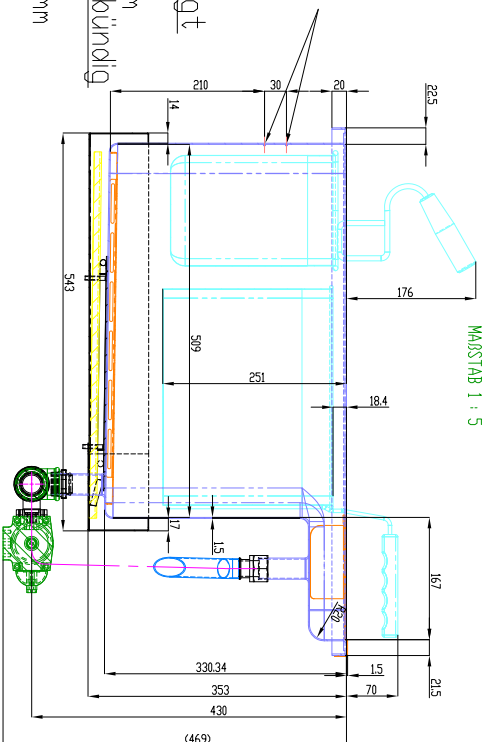

SCHNITT C-C  
MASSSTAB 1:5

Draufsicht  
top view

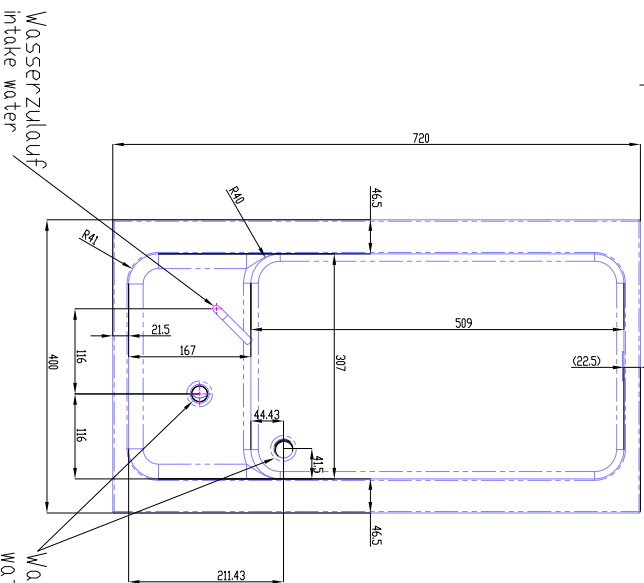

Wasserzulauf  
intake water

Wasserablauf  
water outlet

Schalterblende (optional lieferbar)  
switch panel - optional available

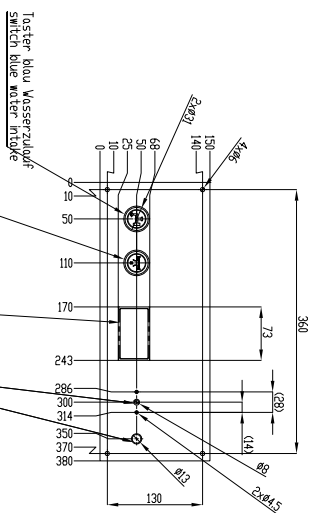

Potentimeter mit Betriebsleuchte grün  
potentiometer with operating light green  
maximale Einbautiefe 110mm  
maximal installation depth

Gerät nicht zum Einschweißen geeignet!  
device is not suitable for welding!

Elektrische-Steereinheit  
electrical control box

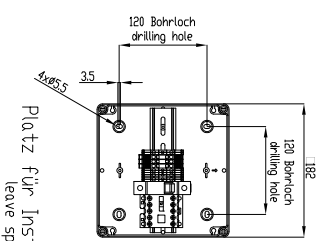

Platz für Installationsdose Schaltung vorsehen  
leave space for installation socket circuit

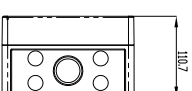

alle Maße in mm  
Allgemeintoleranz = m

|   |   |   |   |   |   |   |   |   |   |    |    |    |    |    |    |
|---|---|---|---|---|---|---|---|---|---|----|----|----|----|----|----|
| A | 1 | 2 | 3 | 4 | 5 | 6 | 7 | 8 | 9 | 10 | 11 | 12 | 13 | 14 | 15 |
| B |   |   |   |   |   |   |   |   |   |    |    |    |    |    |    |
| C |   |   |   |   |   |   |   |   |   |    |    |    |    |    |    |
| M |   |   |   |   |   |   |   |   |   |    |    |    |    |    |    |
| L |   |   |   |   |   |   |   |   |   |    |    |    |    |    |    |
| K |   |   |   |   |   |   |   |   |   |    |    |    |    |    |    |
| J |   |   |   |   |   |   |   |   |   |    |    |    |    |    |    |
| I |   |   |   |   |   |   |   |   |   |    |    |    |    |    |    |
| H |   |   |   |   |   |   |   |   |   |    |    |    |    |    |    |
| G |   |   |   |   |   |   |   |   |   |    |    |    |    |    |    |
| F |   |   |   |   |   |   |   |   |   |    |    |    |    |    |    |
| E |   |   |   |   |   |   |   |   |   |    |    |    |    |    |    |
| D |   |   |   |   |   |   |   |   |   |    |    |    |    |    |    |
| C |   |   |   |   |   |   |   |   |   |    |    |    |    |    |    |
| B |   |   |   |   |   |   |   |   |   |    |    |    |    |    |    |
| A |   |   |   |   |   |   |   |   |   |    |    |    |    |    |    |

|                 |  |                                  |      |       |      |      |      |           |      |      |      |      |      |      |      |
|-----------------|--|----------------------------------|------|-------|------|------|------|-----------|------|------|------|------|------|------|------|
| BEREICH         |  | NAME                             |      | DATUM |      | SSZ  |      | ZEICHNUNG |      | SSZ  |      | SSZ  |      | SSZ  |      |
| GERÄT           |  | 1001                             | 1002 | 1003  | 1004 | 1005 | 1006 | 1007      | 1008 | 1009 | 1010 | 1011 | 1012 | 1013 | 1014 |
| BEMERKUNG       |  | BKEA 1/1E<br>+WAS                |      |       |      |      |      |           |      |      |      |      |      |      |      |
| ZUSAMMENFASSUNG |  | BKEA 1-1E                        |      |       |      |      |      |           |      |      |      |      |      |      |      |
| HERSTELLER      |  | Bayer-Kochsysteme GmbH & Co KG   |      |       |      |      |      |           |      |      |      |      |      |      |      |
| STÜBELEITUNG    |  | Stübeleitungs-IP-67/41 Durchsch. |      |       |      |      |      |           |      |      |      |      |      |      |      |
| WÄRMEDÄMMUNG    |  | Wärmedämmung                     |      |       |      |      |      |           |      |      |      |      |      |      |      |
| MATERIAL        |  | A2                               |      |       |      |      |      |           |      |      |      |      |      |      |      |

Vorderansicht  
front view

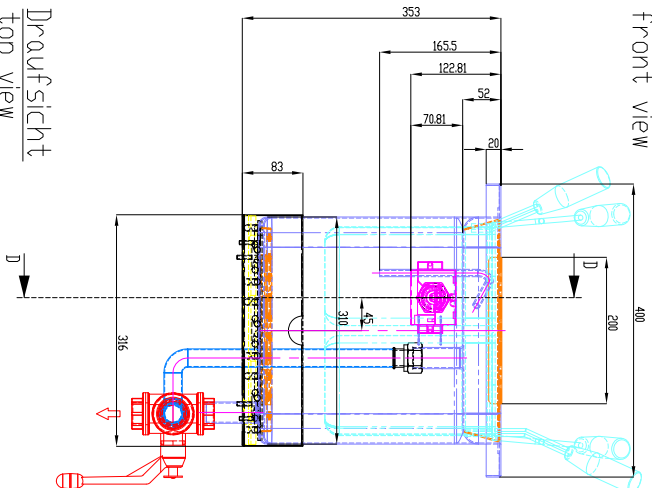

Draufsicht  
top view

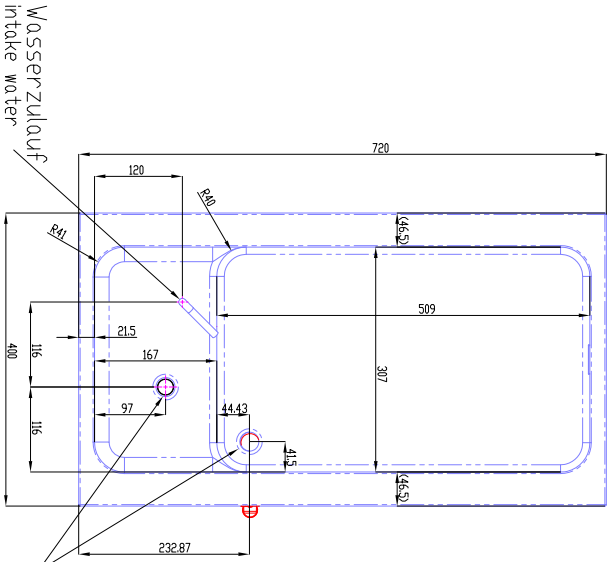

Ausschnitt bei Nudelkocher aufgelegt  
385mm x 705mm  
cut out at cover panel 385mm x 705mm  
Ausschnitt bei Nudelkocher flächenbündig  
eingebaut 408mm x 728mm  
cut out at cover panel 408 mm x 728mm

Schalterblende (optional lieferbar)  
switch panel - optional available

MAX-MIN

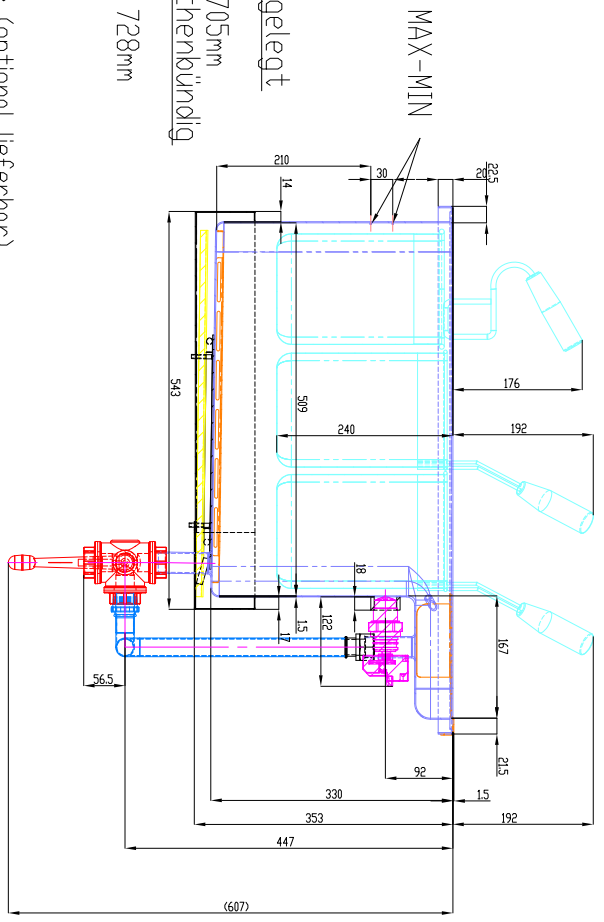

maximale Einbautiefe 110mm  
maximal installation depth

Gerät nicht zum Einschweißen geeignet!  
device is not suitable for welding!

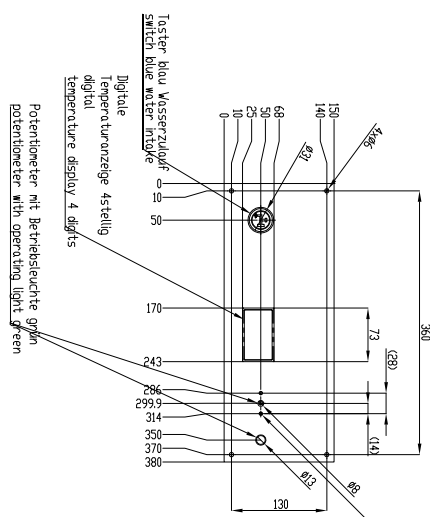

Elektrische-Steuereinheit  
electrical control box

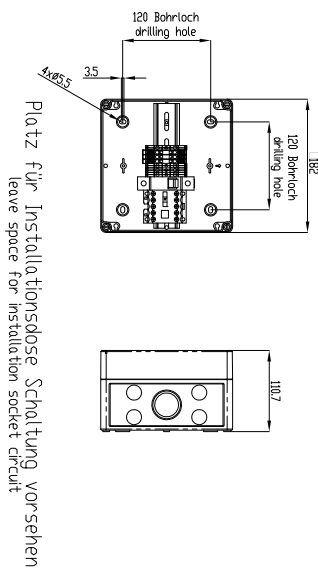

flexibel einbauen / line-key  
flexible installation

- 3-Wegeventil - 3 way valve
- Flexrohr - flexible tube
- Isolation - isolation
- Einbaubrett - sheet to insert
- Abdeckung - cover panel (rip-off)
- Niveauegalierung - niveau control
- Automatische Radlauf - auto drift

| ZEICHEN | NAMM | DATUM      | SSS | REVISION |
|---------|------|------------|-----|----------|
| GERÄT   | WZ   | 01.01.2011 | 01  |          |
| GERÄT   | WZ   | 01.01.2011 | 01  |          |

  

| DATUM      | SSS | INHALT | ANMERKUNGEN |
|------------|-----|--------|-------------|
| 01.01.2011 | 01  | WZ     | allgemein   |
| 01.01.2011 | 01  | WZ     | allgemein   |
| 01.01.2011 | 01  | WZ     | allgemein   |
| 01.01.2011 | 01  | WZ     | allgemein   |

Berger-Kochsysteme GmbH & Co. KG  
 Südfriesenstr. 10-12, 67471 Dornsch  
 www.berger-kochsysteme.de

BKEA 1-IE  
 +WZN

BKEA 1-IE  
 Blatt 3 von 5

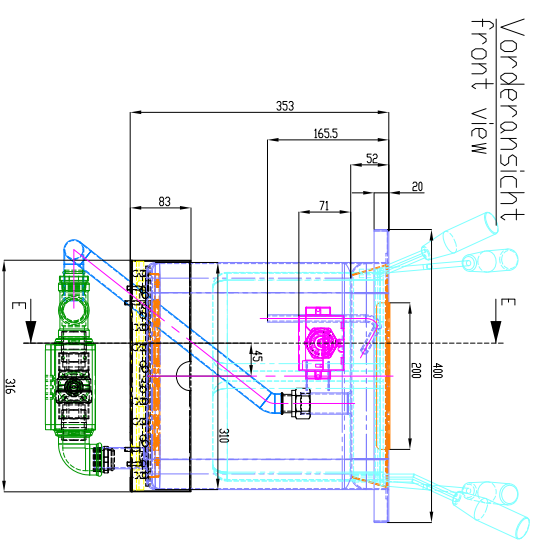

Draufsicht  
top view

Ausschnitt bei Nudelkocher aufgelegt  
385mm x 705mm  
cut out at cover panel 385mm x 705mm  
Ausschnitt bei Nudelkocher flächenbündig  
eingebaut 408mm x 728mm  
cut out at cover panel 408 mm x 728mm

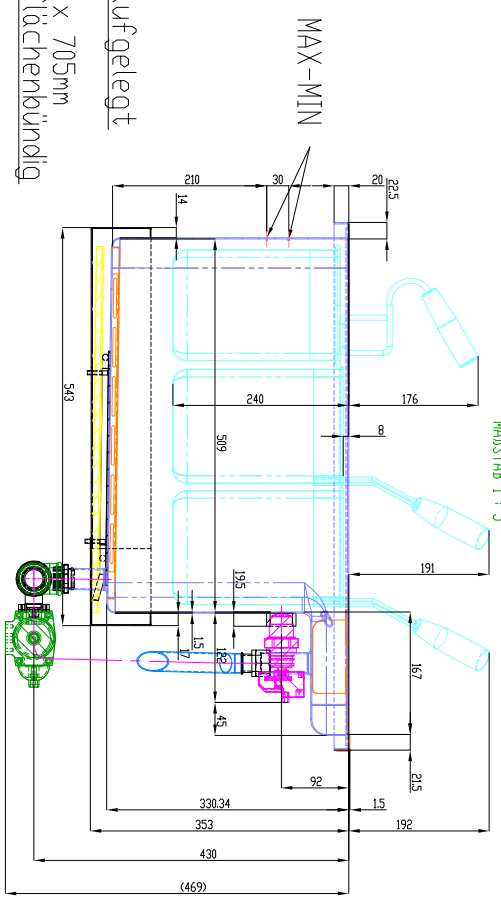

Schalterblende (optional lieferbar)  
switch panel - optional available

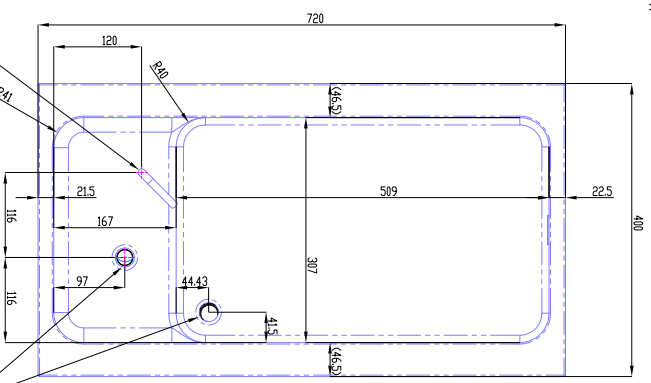

Wasserzulauf  
intake water

Wasserablauf  
water outlet

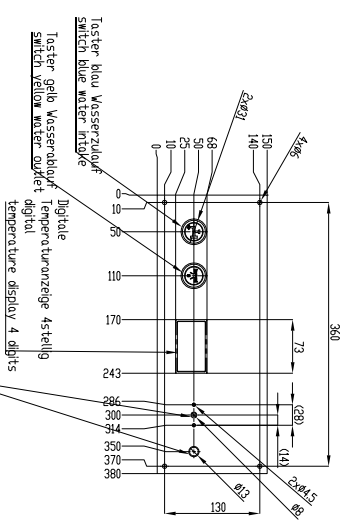

Potentimeter mit Betriebsleuchte grün  
potentiometer with operating light green

Digitale  
Temperaturanzeige 4-stellig  
digital  
temperature display 4 digits

maximale Einbautiefe 110mm  
max. installation depth

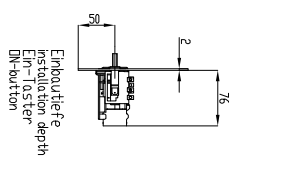

Elektrische Steuereinheit  
electrical control box

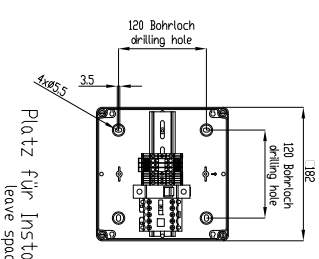

Platz für Installationsdose Schaltung vorsehen  
leave space for installation socket circuit

|   |   |   |   |   |   |   |   |   |    |    |    |    |    |    |   |
|---|---|---|---|---|---|---|---|---|----|----|----|----|----|----|---|
| 1 | 2 | 3 | 4 | 5 | 6 | 7 | 8 | 9 | 10 | 11 | 12 | 13 | 14 | 15 |   |
| A | B | C | M | L | K | J | I | H | G  | F  | E  | D  | C  | B  | A |

| ZEICHENET       | NAME                      | DATUM  | SSS | SSS    | SSS | SSS    | SSS | SSS    | SSS | SSS    | SSS | SSS    | SSS | SSS    | SSS |
|-----------------|---------------------------|--------|-----|--------|-----|--------|-----|--------|-----|--------|-----|--------|-----|--------|-----|
| GERÄT           | WAS                       | ERSTEN | WZ  | ERSTEN | WZ  | ERSTEN | WZ  | ERSTEN | WZ  | ERSTEN | WZ  | ERSTEN | WZ  | ERSTEN | WZ  |
| BEZEICHNUNG     | BKEA 1/1E<br>+WAS<br>+WZN |        |     |        |     |        |     |        |     |        |     |        |     |        |     |
| ZUSAMMENFASSUNG | BKEA 1-1E<br>ZUM 1.09.15  |        |     |        |     |        |     |        |     |        |     |        |     |        |     |
| WÄRMESCHÜTZ     | A2                        |        |     |        |     |        |     |        |     |        |     |        |     |        |     |

Gerät nicht zum Einschweißen geeignet!  
device is not suitable for welding!

alle Maße in mm  
Allgemeintoleranz = m

Hersteller: Berger-Kochsysteme GmbH & Co KG  
Südfriesen-Dr. 87471 Burghausen  
www.burghausen.de

1 2 3 4 5 6 7 8 9 10 11 12 13 14 15

GN2/9

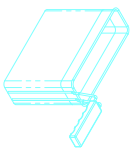
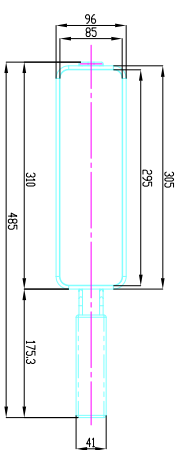
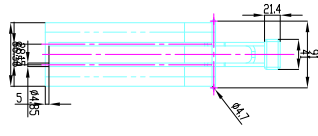
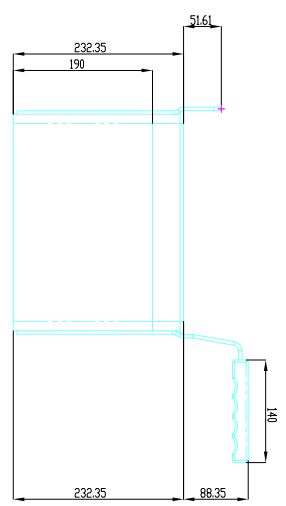

GN1/3

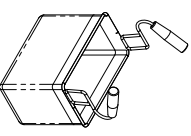
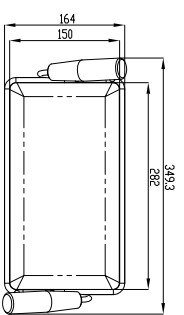
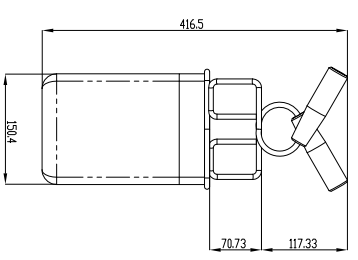
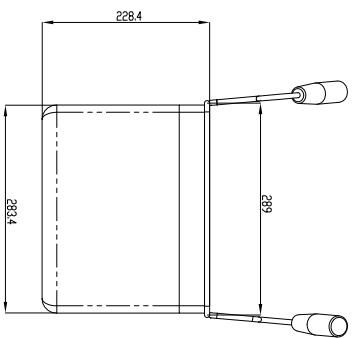

GN1/6 links

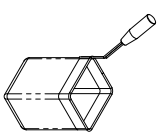
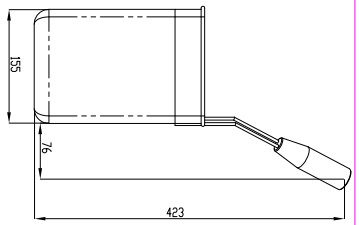
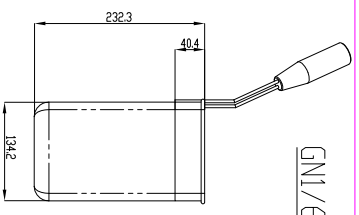

GN1/6 rechts

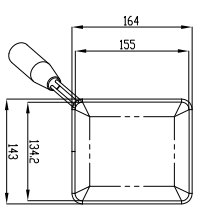
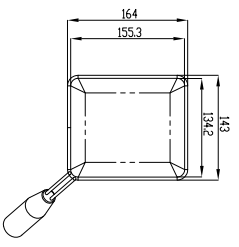
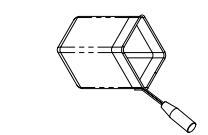
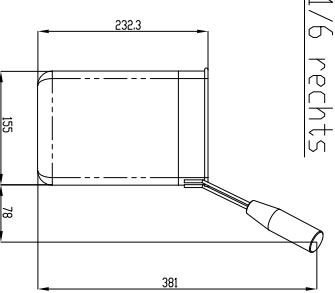

alle Maße in mm  
Abgabetoleranz = m

| ZEICHNUNG | NAME | DATUM   | SS |
|-----------|------|---------|----|
| GEZEIGT   | MAKT | GEZEIGT | MA |
| GEZEIGT   | MAKT | GEZEIGT | MA |

| REVISIONEN | DATUM | SS | INHALT | REVISIONEN |
|------------|-------|----|--------|------------|
| 1          |       | MA | 1      |            |
| 2          |       | MA | 2      |            |
| 3          |       | MA | 3      |            |
| 4          |       | MA | 4      |            |

Optionen BKEA\_1/1E

Berger-Kochsysteme GmbH & Co KG  
Südfrauenstr. 10-12/4711  
www.birger.de

BKEA\_1-1E

A2

1 2 3 4 5 6 7 8 9 10

A2

A B C M L K

1000000000

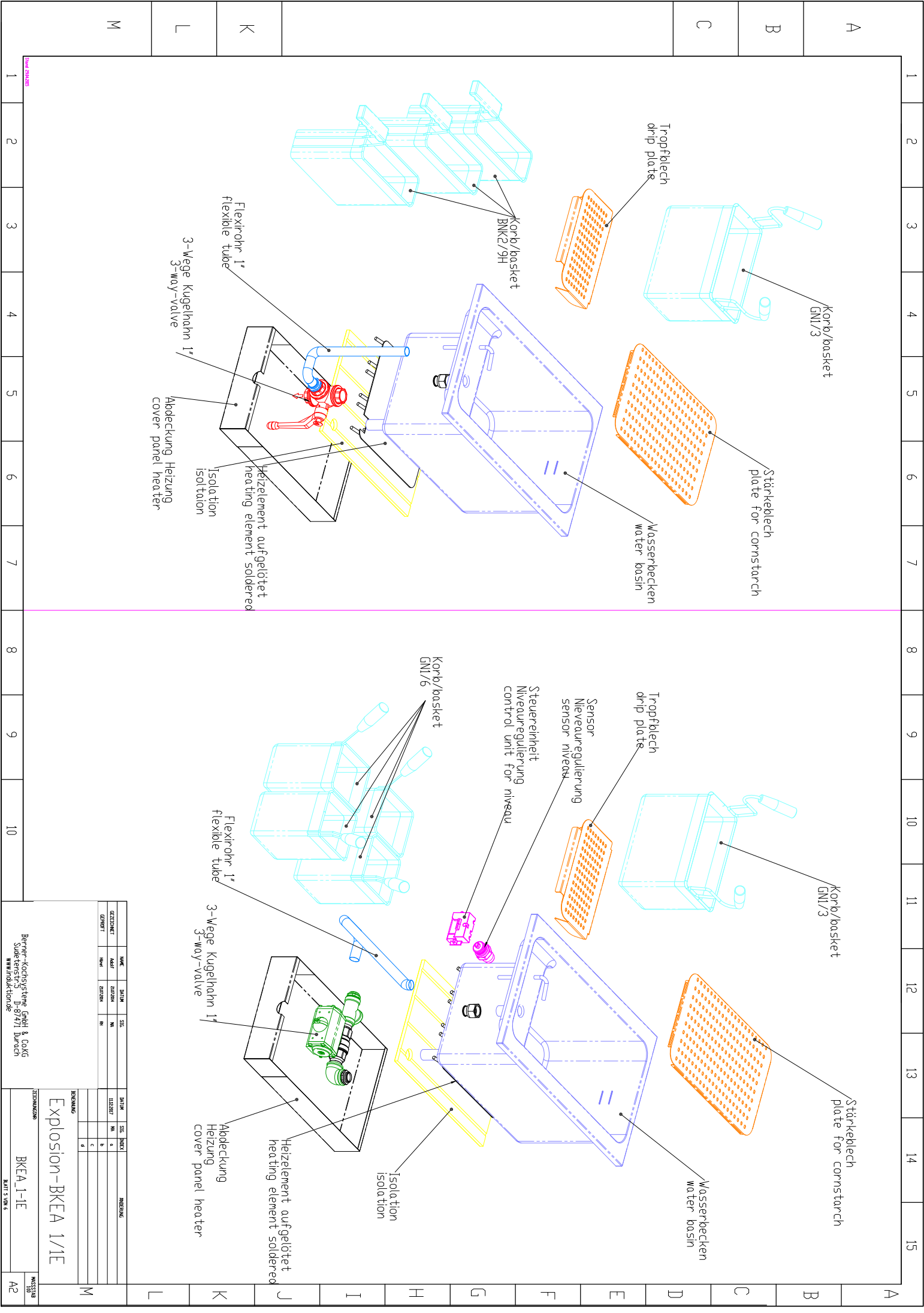

|   |   |   |   |   |   |   |   |   |    |    |    |    |    |    |
|---|---|---|---|---|---|---|---|---|----|----|----|----|----|----|
| 1 | 2 | 3 | 4 | 5 | 6 | 7 | 8 | 9 | 10 | 11 | 12 | 13 | 14 | 15 |
|---|---|---|---|---|---|---|---|---|----|----|----|----|----|----|

| BESTANDTEILE |        | DATUM   |      | SSS  |      | REVISION |      |
|--------------|--------|---------|------|------|------|----------|------|
| ZEICHEN      | ANGABE | STÄNDIG | MA   | NR.  | NR.  | NR.      | NR.  |
| GERÄT        | BAUJ   | BAUJ    | BAUJ | BAUJ | BAUJ | BAUJ     | BAUJ |

BEREICHUNG  
**EXPLOSION-BKEA 1/1E**  
 ZUSAMMENBAU  
 BKEA 1-1E  
 BAUJ 3 01/15

Berger-Kochposten GmbH & Co KG  
 Suderstrasse 11b 67471 Bursch  
 www.burda-torndor.de

A2